

Pontotoc

County, Oklahoma

COUNTY PURCHASING OFFICE

Pontotoc County Clerk

301 S Broadway Ada, Oklahoma

Phone Number +1 (580) 332-8977

Invitation to Bid

PLEASE REVIEW TERMS AND CONDITIONS ON REVERSE SIDE
RELATING TO SUBMISSION OF THIS BID.
Notarized Affidavit completions and signature required on reverse side.

Date Issued Nov 17, 2025

Page 1 of 2

BID NUMBER

#26-08

BID CLOSING DATE AND HOUR

December 15, 2025 9:00 AM

REQUIRED DELIVERY DATE

(Days after award of Purchase Order)

Date of Delivery**TERMS**

The Board of Pontotoc County Commissioners reserve the right to accept or reject any or all bids.

ITEM	QUANTITY	UNIT OF ISSUE	DESCRIPTION	UNIT PRICE	TOTAL
			<p>The concession stand remodel project at the Agri-Plex.</p> <p>Specifications/plans for bid are attached.</p> <p>Department: Agri-Plex Office Hours: 8:00 AM - 4:00 PM Contact: JR Grissom 580.332.9267 Return Bids To: Pontotoc County Clerk *301 S Broadway * Ada, OK 74820 or PO BOX 1425 * Ada, OK 74821-1425</p> <p>PLEASE READ & FOLLOW ALL INSTRUCTIONS:</p> <ol style="list-style-type: none"> 1. Please write sealed Bid #26-08 on the outside of the envelope. 2. Vendor's bid(s) MUST be listed on the front of this form on the line(s) below. Additional information for bid product may be attached. 3. Invitation to Bid form MUST BE SIGNED BY THE VENDOR IN FRONT OF A NOTARY and the original signed and notarized bid form submitted. 4. ALL DOCUMENTS in the bid packet must be completed and returned upon submission of bid. 5. Bids may be received within a 96-hour window before the bid opening December 9th at 9:00 AM to December 15th at 9:00 AM). 		\$

TERMS and CONDITIONS

1. Sealed bids will be opened in the Commissioner's Conference Room, _____ in the Pontotoc County Clerk's Office
County Courthouse, located at 301 S. Broadway _____ Ada, Oklahoma, at the time and date shown on the
invitation to bid form.
2. Late bids will not be considered. Bids must be received in sealed envelopes (one to an envelope) with bid number and
closing date written on the outside of the envelope.
3. Unit prices will be guaranteed correct by the bidder.
4. Firm prices will be F.O.B. destination.
5. Purchases by Pontotoc _____ County, Oklahoma, are not subject to state or federal taxes.
6. This bid is submitted as a legal offer and any bid when accepted by the County constitutes a firm contract.
7. Oklahoma laws require each bidder submitting a bid to a county for goods or services to furnish a notarized sworn statement
of non-collusion. A form is supplied below.
8. Bids will be firm until _____ (Date)

AFFIDAVIT: I, the undersigned, of lawful age, being first duly sworn on oath say the he (she) is the agent authorized by the bidder to submit the above bid. Affiant further states that the bidder has not been a party to any collusion among bidders in restraint of freedom of competition by agreement to bid at a fixed price or to refrain from bidding; or with any state official or employee as to quantity; quality or price in the prospective contract or any other terms of said prospective contract; or in any discussions between bidders and any state official concerning exchange of money or other thing of value for special consideration in the letting of a contract; that the bidder/contractor has not paid, given or donated or agreed to pay, give or donate to any officer or employee of the State of Oklahoma (or other entity) any money or other thing of value, either directly or indirectly in the procuring of the award of a contract pursuant to this bid.

Subscribed and sworn before this _____ day

of _____, 20 _____ (SEAL)

Firm: _____

My commission expires _____

Signed by: _____

(Manual Signature of Undersigned)

Address: _____

Phone: _____

NOTARY PUBLIC (CLERK OR JUDGE)

Zip: _____

In accordance with 62 O.S. § 310.9

NOTE: Other terms and conditions can be added at the discretion of the county officers.

- Tear out existing counters
- Power wash walls & floor
- INSTALL new floor & ceiling
- New receptacles & lights
- STAINLESS Back splash Behind
- Stove, Rebuild vent Hood,
- INSTALL New Equipment
- Paint walls with Tuberculized
- Coating That is Washable

Replace ceiling
in this area

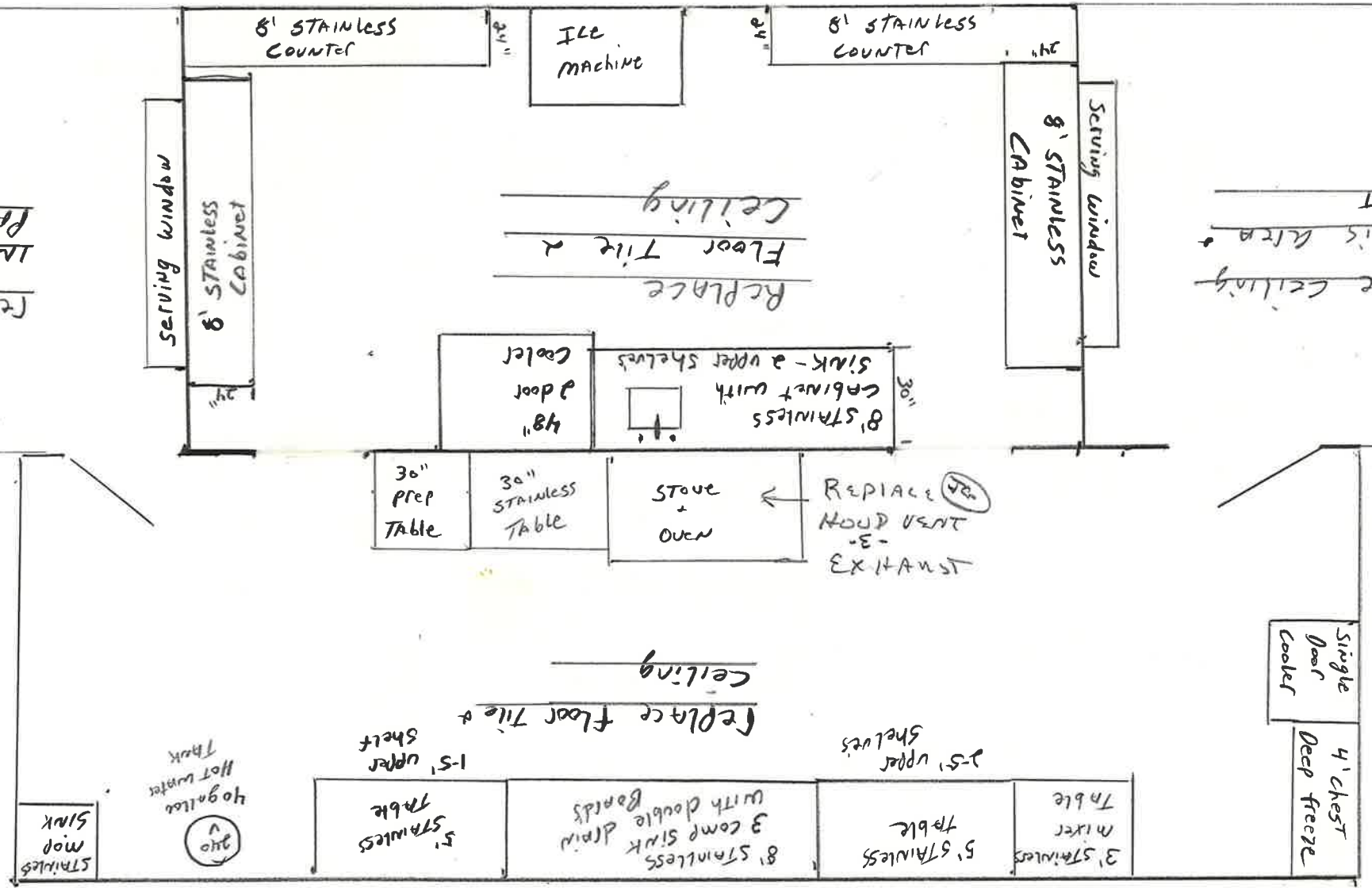

Replace ceiling
in this area

Replace
Floor Tile &
Ceiling